



Republic Vacuum Pump RX-250

R E P U B L I C
Vacuum Pumps®

Republic offers the RX-250 oil lubricated rotary vane vacuum pump. Single stage, air-cooled, and direct-driven, the design is one of the most reliable and simplest pumps available.

Advantages

- ▲ Continuous duty
- ▲ Simple maintenance
- ▲ Higher vacuum capabilities
- ▲ Easy to install
- ▲ Quiet operation

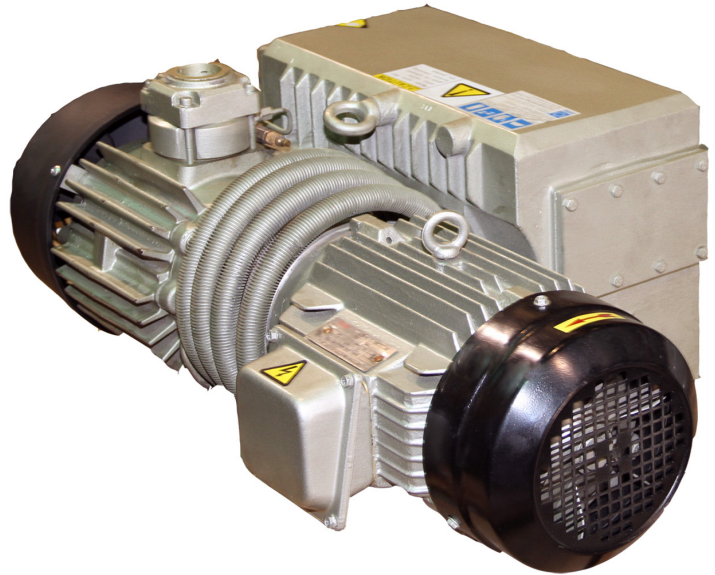

Product Options

- ▲ Air filter (recommended)
- ▲ Vacuum regulating valve
- ▲ Exhaust silencer
- ▲ Vacuum gauge

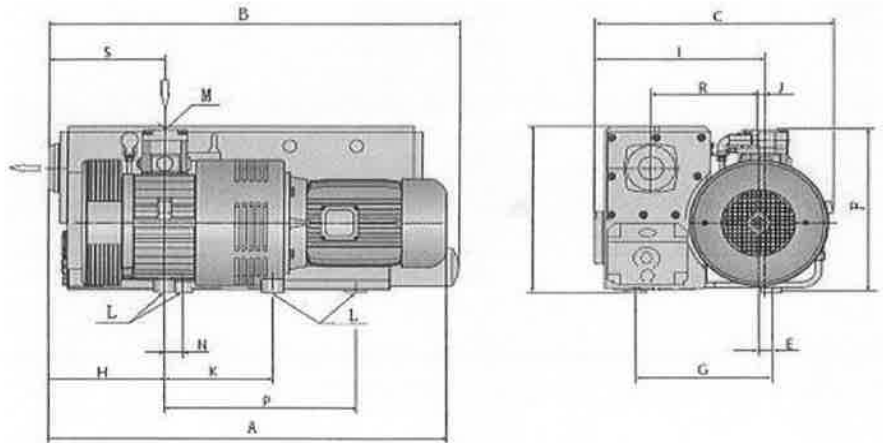

Model	Capacity Max cfm		Ultimate Vacuum Max. (in Hg)		Motor Output Full Load (HP)		Voltage 3Phase (V)		Noise Level (dB)		Weight (lb)
	50 Hz	60 Hz	50 Hz	60 Hz	50 Hz	60 Hz	50 Hz	60 Hz	50 Hz	60 Hz	
RX-250	147.1	180.0	29.92	29.92	7.50	10.0	220/380	230/460	73.0	73.0	430

	A	B	C	D	E	F	G	H	I	J	K	L	M	N	P
Inches	33.7	38.5	22.0	17.3	1.18	16.9	13.9	10.2	15.1	0.78	11.8	4 x M10	2 NPT	1.57	15.3

5131 Cash Road ▲ Dallas, TX 75247 ▲ P 214.631.8070 ▲ F 214.631.3673 ▲ 800.847.0380

www.republicsales.com



Republic Vacuum Pump RX-250

REPUBLIC
Vacuum Pumps®

RX-250 Vacuum Curves

